

# Three-wheel electric forklift 1.5t

## CPD15TVR5

Distinguishing mark			
1.1	Manufacturer		EP
1.2	Model designation		CPD15TVR5
1.3	Drive unit		Electric
1.4	Operator type		seated
1.5	rated capacity	Q	t
1.6	Load center distance	c	mm
1.8	Load distance, centre of drive axle to fork	x	mm
1.9	Wheelbase	y	mm
Weight			
2.1	Service weight (include battery)	kg	3240
2.2	Axle loading, laden driving wheels /steering wheels	kg	4177/563
2.3	Axle loading, unladen driving wheels /steering wheels	kg	1610/1630
Types,Chassis			
3.1	Tyre type,driving wheels /steering wheels		solid rubber
3.2	Tyre size, driving wheels		18X7-8
3.3	Tyre size, steering wheels		18X7-8
3.5	Wheels, number driving/steering (x=drive wheels)	mm	2/1X
3.6	Tread, Driving wheels	b <sub>10</sub>	mm
3.7	Tread, Steering wheels	b <sub>11</sub>	mm
Dimensions			
4.1	Tilt of mast/fork carriage forward/backward	$\alpha/\beta$ (°)	3/6
4.2	Height, mast lowered	h <sub>1</sub>	mm
4.3	Free lift (load backrest)	h <sub>2</sub>	mm
4.4	Lift height	h <sub>3</sub>	mm
4.5	Height, mast extended	h <sub>4</sub>	mm
4.7	Height of overhead guard (cabin)	h <sub>6</sub>	mm
4.8	Seat height	h <sub>7</sub>	mm
4.12	Tow center of pin height	h <sub>10</sub>	mm
4.19	Overall length	l <sub>1</sub>	mm
4.20	Length to face of forks	l <sub>2</sub>	mm
4.21	Overall width	b <sub>1</sub> /b <sub>2</sub>	mm
4.22	Fork dimensions	s/ e/ l	mm
4.23	Fork carriage class/type A, B		2A
4.24	Fork carriage width	b <sub>3</sub>	mm
4.31	Ground clearance, laden, below mast	m <sub>1</sub>	mm
4.32	The minimum ground clearance of frame	m <sub>2</sub>	mm
4.34.1	Aisle width for pallets 1000 × 1200 crossways	Ast	mm
4.34.2	Aisle width for pallets 800 × 1200 lengthways	Ast	mm
4.35	Turning radius	Wa	mm
Performance data			
5.1	Travel speed, laden/ unladen	km/ h	12/12.5
5.2	Lifting speed, laden/ unladen	m/ s	0.30/0.52
5.3	Lowering speed, laden/ unladen	m/ s	0.59/0.52
5.5	Drawbar pull, laden/unladen	N	/
5.6	Max. drawbar pull, laden/unladen (time)	N	/
5.7	Gradeability, laden/unladen	%	6.5/11
5.8	Max. gradeability, laden/unladen	%	—
5.10	Service brake type		Hydraulic / Mechanical
	park brake type		Hydraulic / Mechanical
Electric-engine			
6.1	Drive motor rating S2 60 min	kW	6.5
6.2	Lift motor rating at S3 15%	kW	8.2
6.3	The maximum allowed size battery	mm	—
6.4	Battery voltage/nominal capacity K5		48/400
6.5	Battery weight	kg	667
Addition data			
8.1	Type of drive unit		AC
10.5	Steering type		Hydraulic / Mechanical
10.7	Sound pressure level at the driver's ear	dB (A)	68

- 1.The parameters in the table are of the standard model. For more information, please contact us.
- 2.The parameters are subject to change without notice.

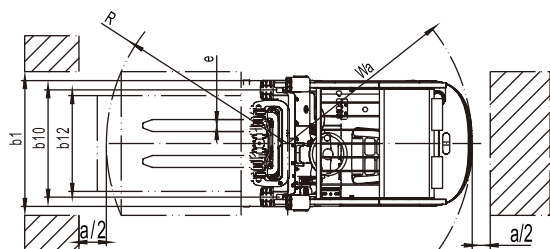
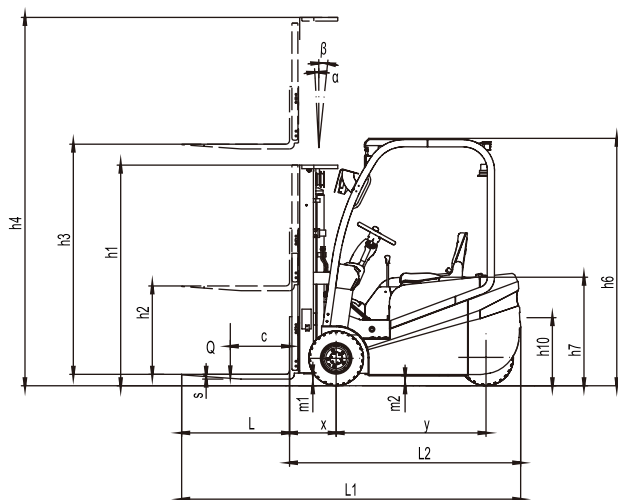

$$Ast = Wa + R + a$$

## Option

options	CPD15TVR5
Fork length	•
Folding fork	•
Imported battery	•
No-mark solid tire	•
Cold storage (Apply to -20℃)	•
Lateral battery change	•
Fork weighing system	•
Customized Overhead height	•
Mast lifting height	•
Attachment	•
Integrated side shift	•
LED Front working light	•
fire extinguisher	•
Auto-filling water system	•
Suspension seat	•
Dual Mirrors	•
OPS	•
Rear working light	•
Special backrest	•
FAN	•
Charger (220/380V)	•
battery trolley for lateral battery extraction	•
Special modification for Drive-in Racking	•

